

Backing flange PP with steel core

PPST-2017-09-06-e

Model:

- PP-GF30 black (30% glas-fibre reinforced) with steel core
- UV-resistant. Applicable for outside applications
- Connecting-dimensions: ISO 7005, EN 1092, DIN 2501
- Bolt circle PN 10

Suitable for socket and butt fusion systems metric (no pictograph on flange)

Artikel-Nr.	Dimension	d	DN	PN	kg	D	D1	D2	D3	H	AL	SC	€/piece net price
206-020-M	D20DN15	20	15	16	0,22	95	65	28	14	12	4	M12	2,22
207-025-M	D25DN20	25	20	16	0,26	105	75	34	14	12	4	M12	2,45
208-032-M	D32DN25	32	25	16	0,43	115	85	42	14	16	4	M12	3,08
209-040-M	D40DN32	40	32	16	0,65	140	100	51	18	16	4	M16	3,65
210-050-M	D50DN40	50	40	16	0,82	150	110	62	18	18	4	M16	4,35
211-063-M	D63DN50	63	50	16	1,02	165	125	78	18	18	4	M16	5,47
212-075-M	D75DN65	75	65	16	1,34	185	145	92	18	18	4	M16	6,08

For socket fusion systems metric

Artikel-Nr.	Dimension	d	DN	PN	kg	D	D1	D2	D3	H	AL	SC	€/piece net price
213-090-M	D90DN80	90	80	16	1,40	200	160	110	18	20	8	M16	7,39
214-110-M	D110DN100	110	100	16	1,56	220	180	133	18	20	8	M16	10,05
215-125-M	D125DN125	125	125	16	2,59	250	210	150	18	24	8	M16	10,66
216-140-M	D140DN125	140	125	16	2,12	250	210	167	18	24	8	M16	12,63
217-160-M	D160DN150	160	150	16	3,69	285	240	190	22	24	8	M20	15,86
219-200-M	D200DN200	200	200	16	5,85	340	295	226	22	27	8	M20	22,71
220-225-M	D225DN200	225	200	16	4,41	340	295	250	22	27	8	M20	22,71
221-250-M-12L	D250DN250	250	250	16	8,34	395	350	277	22	30	12	M20	28,30
222-280-M	D280DN250	280	250	16	5,52	395	350	310	22	30	12	M20	28,30
223-315-M	D315DN300	315	300	16	7,60	445	400	348	22	34	12	M20	42,08
224-355-M	D355DN350	355	350	16	13,96	515	460	388	23	40	16	M20	83,47
225-400-M	D400DN400	400	400	16	17,38	574	515	442	26	40	16	M24	94,97

For but fusion systems metric

Artikel-Nr.	Dimension	d	DN	PN	kg	D	D1	D2	D3	H	AL	SC	€/piece net price
313-090-S	D90DN80	90	80	16	1,40	200	160	108	18	20	8	M16	7,39
314-110-S	D110DN100	110	100	16	1,58	220	180	128	18	20	8	M16	10,05
315-125-S	D125DN100	125	100	16	1,55	220	180	135	18	20	8	M16	10,66
316-140-S	D140DN125	140	125	16	2,36	250	210	158	18	24	8	M16	12,63
317-160-S	D160DN150	160	150	16	3,89	285	240	178	22	24	8	M20	15,86
318-180-S	D180DN150	180	150	16	3,41	285	240	188	22	24	8	M20	15,86
319-200-S	D200DN200	200	200	16	5,18	340	295	235	22	27	8	M20	22,71
320-225-S	D225DN200	225	200	16	5,15	340	295	238	22	27	8	M20	22,71
321-250-S	D250DN250	250	250	16	6,68	395	350	288	22	30	12	M20	28,30
322-280-S	D280DN250	280	250	16	6,58	395	350	294	22	30	12	M20	28,30
323-315-S	D315DN300	315	300	16	8,42	445	400	338	22	34	12	M20	42,08
324-355-S	D355DN350	355	350	16	15,79	515	460	376	23	40	16	M20	83,47
325-400-S	D400DN400	400	400	16	19,32	574	515	430	26	40	16	M24	94,97

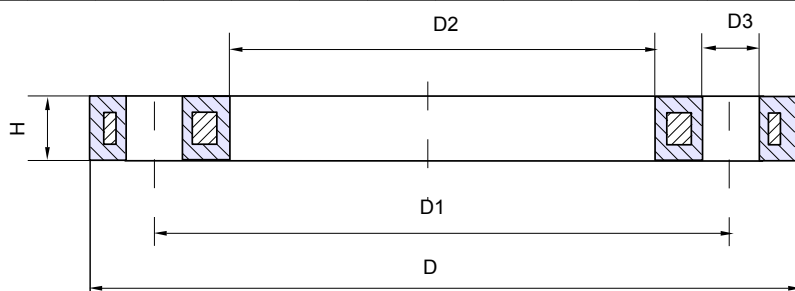

Net prices: ex Works

Minimum order value: 50,-€

Technical modifications subject to change.

We take no responsibility for printing errors.

Inch-dimensions on demand

Please contact us for special bulk discount prices.

Präziform Kunststofftechnik
GmbH & Co. Kommanditgesellschaft

Werkstraße 15
D-52076 Aachen

Tel. +49 2408 4577
Fax +49 2408 6148

www.praeziform.de
kontakt@praeziform.de